

Winter novelties in **KAN-therm** offer!

KAN Company is a manufacturer of modern water and heating systems, which attaches great value to the continuous development of its products and material offer. Our goal is to provide clients with innovative products of the highest quality. We know that thank to such approach, it will be possible to use them in the most demanding and prestigious investments around the world.

Last months in **KAN** Company were full of intensive works on development of **KAN-therm** System. The result of this work is a whole group of new elements implemented to our offer.



On the following pages we will present and describe some of them.

We invite you to read.

KAN-therm Push SYSTEM

Diameter 12x2

As the present day, market of installation materials shows that minimizing costs of investment realization is already a standard. New trends in energy efficiency of piping systems are forcing manufacturers to deliver products enabling realization of this type of solutions.

In the offer of **KAN-therm** Push System these types of products are PE-Xc and PE-RT pipes as well as brass and PPSU fittings in diameter 12x2 mm. These elements are great for hydraulic optimization of heating systems (radiators or wall heating) and along with low-temperature heat sources (condensing boilers, heat pumps) constitute a fully professional, energy efficient heating system.

An excellent proof of the great interest in this type of solutions in the market is increased demand for pipes and fittings of **KAN-therm** Push System in 12x2 mm diameter.

In connection with the above, **KAN** Company, in the interest of the client and availability of the popular products, has decided to increase the stock status of **KAN-therm** Push elements with 12x2 mm in diameter.

In **KAN-therm** catalogue, limited availability of pipes and fittings in 12x2 diameter has been removed - from now on, these elements are available "on stock".

KAN-therm Push SYSTEM

Looking for savings?

Aim at 12!

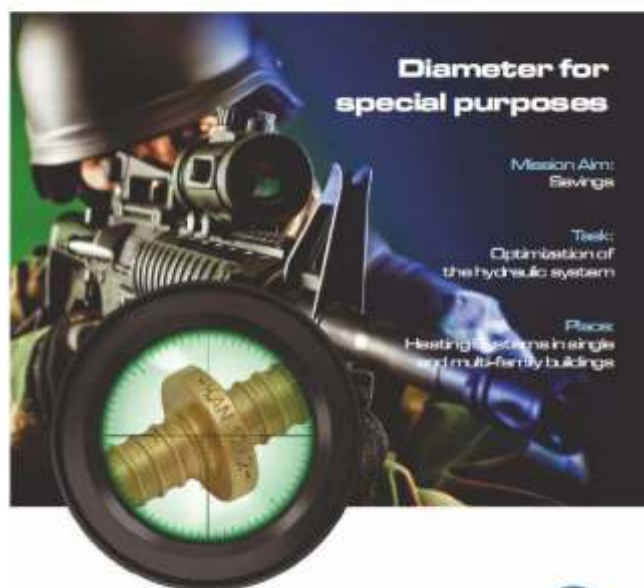

Diameter for special purposes

Mission Aim:
Savings

Task:
Optimization of the hydraulic system

Place:
Heating systems in single and multi-family buildings

kan-therm.com



New fittings "Push"

The fittings offer for domestic water systems has been extended. The new wallplate elbow, directly fixed 25x3, 5 3/4 " has been introduced. This solution is designed for receivers with higher temporary demand for water (washing machines, urinals, pressure cistern) and effectively contributes to reduce noise of flowing medium. This elbow is sold without plastic plug for leak testing.



Catalogue code 9017.350

Installation Tools - Accessories

For Novopress tools, for **KAN-therm** Push assembly, charger L-1810 for battery 9.6 V 3.0 Ah has been introduced to the offer. The charger supports batteries used in the press machine Novopress AAP101 on a standard basis and expanding tools Novopress AXI101 used in **KAN-therm** Push System. Currently, in addition to full set of tools Novopress, a charger can be bought separately.



Novopress battery charger catalogue code 17047-50



Platinum Promotion - Platinum pipes

Recently, we informed you about the introduction of new, universal **KAN-therm** Push Platinum System. The system is based on multi-layer pipes PE-Xc/Al/PE-HD Platinum and PPSU or brass fittings of **KAN-therm** Push System connected by sliding sleeve.

Thus, we would like to remind you about the current "Platinum Promotion" of **KAN-therm** Push Platinum System.

Any person who conducts activity as regards execution of sanitary and heating installations and buys products covered by Platinum System promotion (Platinum multilayer pipes or fittings Platinum) will be able to obtain a set of hand tools for assembly **KAN-therm** Push Platinum System already for 1 Euro.

Do not wait! Number of awards is limited!
Join promotion today!

Details and regulations are available on **KAN** website.

KAN-therm Push Platinum SYSTEM
Reliability and prestige



Platinum Promotion

Get Your tool set worth of 750 Euro for just: 1 Euro!

Do not hesitate- the number of sets is limited. The rules of promotion are available on our website.

kan-therm.com



Assembly tools - new sets

The offer of assembly tools for **KAN-therm** Push Platinum System has been extended by new set of hand tools:

Set – manual chain Push Platinum tool.

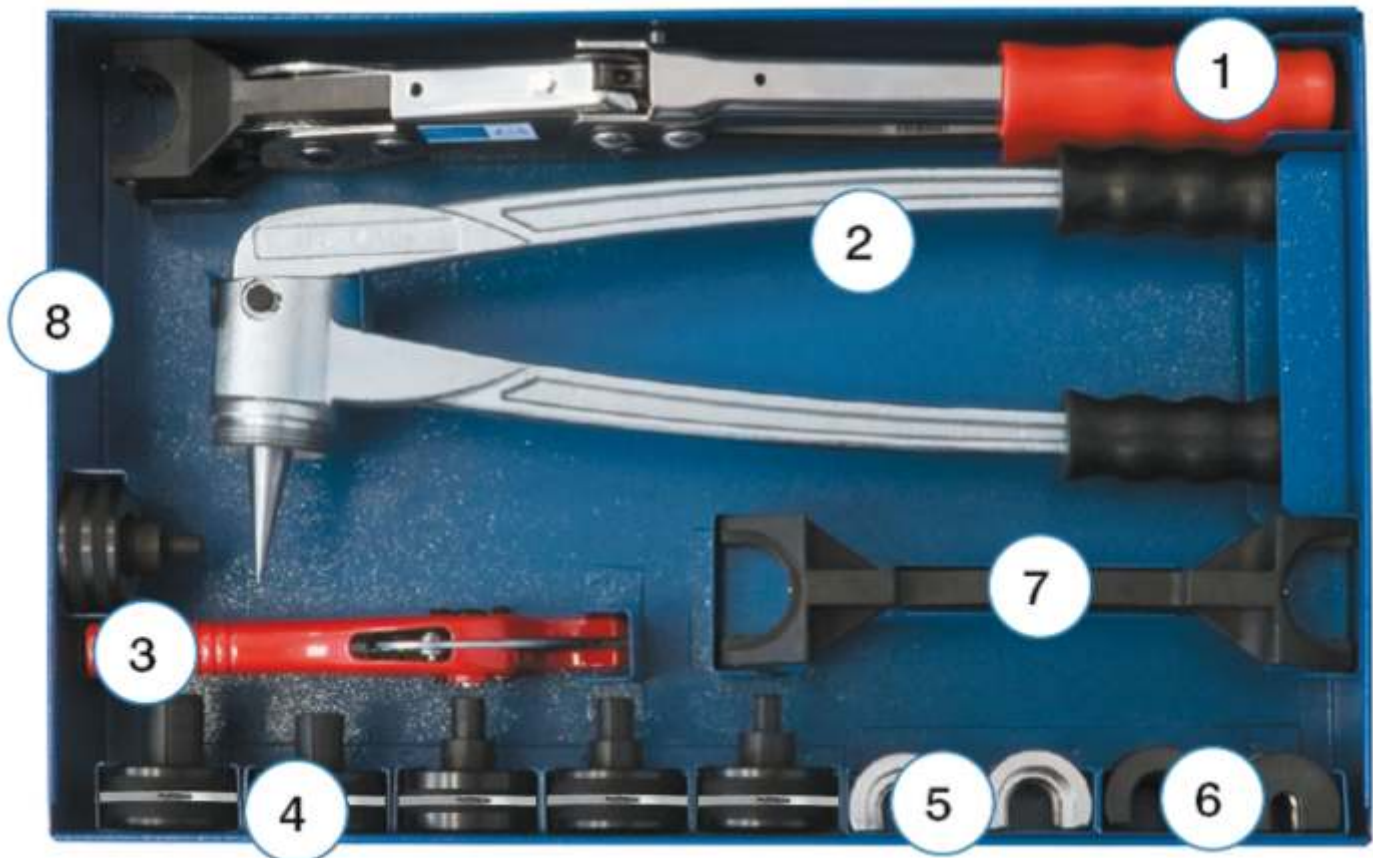

Set catalogue code: KPPR-PLAT

The set includes:

1. manual chain Push Platinum tool.
2. expanding tool for pipes
3. pipe cutter
4. set of Platinum expanding heads: 14 × 2, 18 × 2.5, 25 × 3.5, 32 × 4.4
5. set of ring inserts (12, 14, 18, 25) - 2 pcs
6. set of plastic fittings inserts (T12, T14, T18, T25) - 1 psc
7. two pairs of jaws to connect diameters 12-18mm and 25-32mm
8. case

Due to the fact that there are expanding heads for Platinum pipes in the set, it can be used only for **KAN-therm** Push Platinum System assembly.

KAN-therm Press SYSTEM

New fittings "Press LBP"

The offer of **KAN-therm** Press LBP System has been extended by new versions of fittings for domestic water system.

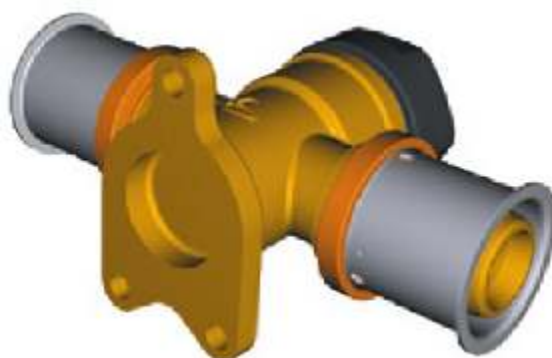

Flat wallplate elbow, directly fixed 20x2 1/2"
Fitting catalogue code: K-085010

Fittings set with metal mounting plate is perfect for making domestic water outlets in so called "dry method".



A set of wallplate elbows on mounting plate 16x2 1/2 "
Set catalogue code: K-201050

Tools for assembly - Did you know ...

Observing the installation market you may see that more and more companies involved in the water system assembly, apply new professional set of tools. Contractors more frequently resign from manual sets for new electric, battery tools.

All this is done to maximally simplify assembly work, speed up the execution time, and, first of all, to improve comfort on the construction site. Therefore, we would like to remind you that **KAN-therm Press LBP System** offers two types of electric battery tools for pipes and fittings assembly.

One of them is the battery press machine REMS with battery and charger unit in a metal case.



The set should be separately completed by press jaws set in the most common diameters 16-32 mm, the most popular in single-family buildings.

The press machine allows mounting diameters in 16-63 mm. Weight of the drive, without the battery, is 4.3 kg. The set has on a standard basis Li-Ion battery with capacity of 14.4 V 2.2 Ah.

An alternative for tools under REMS brand is a set of modern and professional tools Novopress. The set contains battery press machine Novopress "Mini" AFP101, two batteries, battery charger, a set of jaws 16-32 mm with press profile "U" and a plastic case.

The press machine allows for mounting diameters in 16-40 mm. Weight of the drive, without the battery, is 1.9 kg. This kit has on a standard basis two batteries 9,6 V NiMh with a capacity of 3.0 Ah. A new sets of tools Novopress "Mini", have comparable level of price, offers much more convenience work by a significant size and weight reduction of the tool, doesn't need permanent access to electricity and includes two batteries in a



KAN-therm PP SYSTEM

New PP fittings with threads

Range of fittings with threads of **KAN-therm** PP System has been extended by two new elements, such as the female elbow GW 1" and the male elbow GZ 1". Both variants relate to 32 mm diameter.



Male elbow 32 1 "-
fitting catalog code 04104534



Female elbow 32 1 "-
fitting catalog code 04104634

Pipes PP Glass – availability

Polypropylene pipes stabilized with glass fiber, so-called pipes PP Glass, have become already popular on the installation market in the country and abroad. Its usability has been recognized by almost all installers and this resulted in a significant increase in market demand for this type of pipe, even in the larger diameters of 75-110 mm. To meet these requirements, **KAN** company as one of the largest suppliers of PP Glass pipes in Europe, decided to increase quantity regarding orders for this type of pipe. Therefore, we want to inform that in the new edition of **KAN-therm** catalogue, pipes Glass PP, in whole range of diameters 16-110 mm are available "on stock".





Manifolds, cabinets, supplementary elements

Manifolds with adjustable clamp and spacing 100mm - Series 82

KAN is a company that, above all, aims to full satisfaction of a client. We try to be closer to our regular partners and clients, listen to their needs and implement these needs in practice. One example of such constructive cooperation is new **KAN-therm** manifold with adjustable clamp and outlet spacing 100 mm. In **KAN-therm** catalogue 11\2012 new manifolds have serial number 82.



The special design of the manifold clamp allows for vertical adjustment of beams spacing in the range from 250 mm to 400 mm, every 41 mm and has increased to 100 mm output spacing on particular heating circuits, which allows you to connect to the manifold every control and measurement equipment e.g. water meters or heat meters. Supply and return beams are made of brass profile equipped with internal threads of 1" diameter. The outputs for each heating loops are made in the form of internal threads with a diameter of 1/2".

KAN-therm catalogue has manifolds in the configuration of two, three and four circuits. We invite you to get acquainted with new manifolds **KAN-therm** today already.

Nippel for flat sealing

The special nipple 1/2" as an additional equipment for new manifolds 82 series, has been introduced to **KAN-therm** offer.



Catalogue Code: P12

The element is equipped with a special O-ring which seals the junction (nipple with manifold body). Special nipple design enables for sealing "Euroconus" (self-sealing connection with the use of connectors) on the one side and using a flat seal on the other (quite common solution in control and measurement equipment design).



Catalogue Code: P12

KAN-therm Steel SYSTEM

New fittings with threads

In **KAN-therm** catalogue you may find new configuration of **KAN-therm** Steel fittings with threads. This time the offer has been extended by Steel male adapter (35 mm fitting with external thread R1 ").



Fitting catalogue code: 6341247

Underfloor heating

Multilayer pipes in coils

Surface heating is a specific heating system in which the length of a single heating loop can measure up to 120 m. Using conventional pipes in coils with lengths not exceeding 200 m., we get quite a large number of so-called pipe scraps that may be problematic for re-use in underfloor heating systems.

Therefore, **KAN** Company successively introduces plastic pipes in 600 m coils to its offer of underfloor heating. Another version of this type of product is a multilayer pipe PE-RT/Al/PE-RT with diameter 16x2 in 600 m coil.



Pipe catalogue code 0.9616

In order to facilitate pipe unwinding during assembly, **KAN-therm** provides also special uncoilers for pipes in coils.



Elements to reinforce floors

Floor heating is a heating system in which the heating element is a concrete slab with pipes placed into. Pipes heat concrete floor, which further gives off heat to the surroundings / room in which floor heating is assembled.

As a result of heating or cooling, concrete slab undergoes so-called thermal movements. To eliminate cracking phenomenon of concrete floor caused by thermal elongation, proper protection elements are used.

The most popular method, used for years, is to add so called plasticizer **BETOKAN** to concrete. These additives improve strength of the floor and protect against cracks formation.

Very often, the process of floor cracking is accompanied by the formation of so-called steps in place of concrete slab cracks, causing the level difference of cracked parts of the floor.



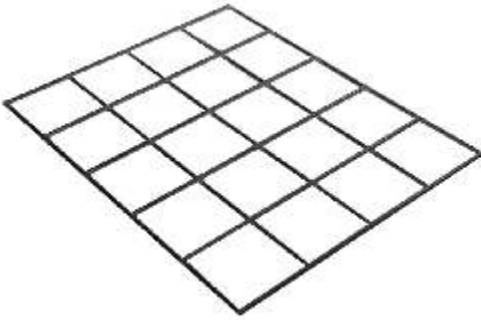

Until now, in order to effectively reduce the size of this phenomenon, in addition to plasticizers BETOKAN, steel reinforcing net (made of steel wire) has been used. Unfortunately, these products were not popular because of the problems arising of their specific material and use - a relatively large weight, large size for transport, the problem to match with room shape, difficult cutting and possibility of corrosion. There are just some of shortcomings which reduce the popularity of this type of protection of floor heating.

To new **KAN-therm** catalogue we introduced a new, highly durable, reinforcement net made of glass fiber. In comparison to its counterpart made of steel wire, plastic net made of glass fiber is characterized by:

- Low weight due to material from which it is made - easy to transport
- Easy and simple cut - easy to adjust to the room shape, even an irregular shape;
- Lack of "shape memory" - net is not strained when laying so the installation is very easy;
- Absence of corrosion due to the material from which it is made;
- Possibility of using very thin concrete screed;
- No electric conductivity;

Net used with concrete additive BETOKAN increases floor flexibility and this is a perfect protection against the possible formation of cracks and faults, retains flat floor surface.

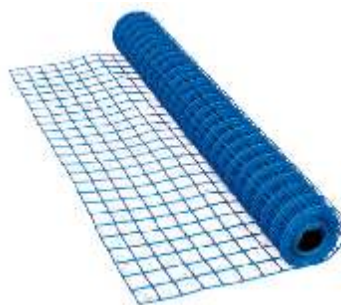

Catalogue Code K-500310

Fastenings for pipes and fittings "GIGA SIZE"

KAN-therm Inox System, as one of the few plumbing systems in the European market, offers pressed pipe and fittings "GIGA SIZE" with diameters 139 mm and 168 mm. These specific, large pipe and fitting diameters made of stainless steel 1.4404, can be used in non - standard industry and technological installations requiring very large flows. In new **KAN-therm** catalogue, the fastenings offer has been extended by clamps for pipes and fittings in Inox GIGA SIZES:

- Single clamp with rubber insert 139 mm – catalogue code: UP-G139
- Single clamp with rubber insert 168 mm – catalogue code: UP-G168



We invite you to download the new
KAN-therm catalogue 11/2012

KAN Sp. z o.o.

ul. Zdrojowa 51, 16-001 Białystok-Kleosin, tel. 0048 85 74 99 200, fax 0048 85 74 99 201,
e-mail: kan@kan.com.pl